

Altona Refinery – Here for the long haul

As the Australian fuel industry goes through a period of significant structural change, Mobil is committed to ensuring the ongoing success of Altona Refinery.

A number of factors, including external market influences, past investment decisions and the hard work of dedicated and highly-skilled employees, have combined to uniquely position Mobil Altona Refinery as a thriving business that continues to defy Australia's tough manufacturing environment.

Over the last five years, Mobil has invested more than \$400 million in safety, efficiency and reliability improvements, building a strong foundation which will allow the Altona Refinery to capitalise on future opportunities for growth. Some examples of these recent investments are outlined below.

Altona Refinery pre-flash project

In 2016, Mobil increased Altona Refinery's production capacity for the first time since 2005. The preflash project saw the refinery's production capacity grow from 80,000 to 90,000 barrels per day, helping to meet Australia's growing transportation fuel demands.



Altona Refinery site renewal

Between 2015 and 2017 Mobil undertook major improvements and refurbishments to a number of Altona Refinery buildings, to bring the buildings in line with new ExxonMobil safety standards and to provide a more pleasant and modern environment for refinery workers.



Trucked crude receipt facility

In 2016 Mobil commissioned a new facility that for the first time, allows receipt of land-locked and competitively priced condensate from local fields by truck, for processing at Altona Refinery.



Demolition of Altona Refinery's Thermoform Catalytic Cracker

Between 2017 and 2018, the Altona Refinery Thermoform Catalytic Cracker, which was decommissioned in 1997, was demolished, freeing up valuable space that could be used for future refinery projects.



Crude import facility improvements

In recent years, Mobil has made several key improvements to the Gellibrand Marine Crude Import Facility, to almost double its capacity and improve the cost effectiveness and efficiency of Altona Refinery's crude import operations. Improvements including channel deepening, new loading arms and pipeline improvements mean the facility can now receive Suezmax class tankers carrying up to one million barrels of oil.



Jet fuel treater expansion

In 2018, Mobil completed works to improve the capacity of Altona Refinery's jet fuel treater. Production capacity of the jet fuel treater increased by 20 percent.



New crude tank at Altona Refinery

Mobil is constructing a new crude tank at Altona Refinery, increasing the refinery's crude storage capacity by around 50 percent and improving the efficiency of its operations. Construction will commence in mid-2018.

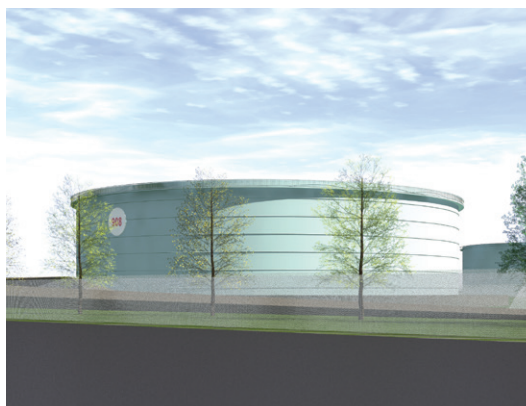

Yarraville tanks

Mobil is constructing two tanks at the Yarraville Terminal. The jet fuel tank will help improve reliability of the supply of jet fuel to Melbourne Airport. The unleaded tank will support Altona Refinery's competitiveness by providing flexibility to ship unleaded fuel produced by the refinery to other Australian locations.



Other jet fuel investments

Mobil is currently constructing a 3km pipeline that will connect Yarraville terminal to the Somerton pipeline, which provides fuel to Melbourne Airport. The pipeline will help improve the resilience of jet fuel supply to Melbourne Airport. As operator of the Melbourne Airport JUHI joint venture, Mobil is managing the construction of two new jet fuel tanks at the JUHI.